

NOTES (UNLESS OTHERWISE INDICATED):

- MATERIAL: C19010, CuNiSi R580;
- OPERATION TEMPERATURE: -40~+150C
- PRESS-FIT AREA
ENNOVI STANDARD 0.64EON, OPTIONAL 0.64HFEON
- FINISH SPECIFICATION
ZONE I (PRESS-FIT AREA): INDICOAT, REFER TO BELOW PLATING TABLE
ZONE II: 0.76~1.5um MATTE Tin, 1.0~2.0um Ni; OR CUSTOMERIZED
ZONE III: TRANSITION AREA, Ni PLATING, Sn ALLOWED
- ALL DIMENSIONS AFTER PLATING
- PCB FINISH: RECOMMENDED ImmSn, OPTIONAL ImAg/OSP
PCB HOLE CONSTRUCTION: SEE BELOW CHART
- PRESS FIT DIMENSION REFER TO DRAWING E-MLG03035-APP;
PRESS FIT PLATING REFER TO DRAWING E-MLG03035-FIN.

PART NUMBER	ZONE I PRESS-FIT AREA "TOP PLATE"	ZONE I PRESS-FIT AREA "UNDERPLATE"
E-MLG03035-FIN-3 (INDICOAT)	0.3 - 1.1 μm [12 - 45 μin] • INDIUM • POST-PLATED • ELECTRODEPOSITED	1.0 - 3.0 μm [39 - 120 μin] • SULFAMATE NICKEL • POST-PLATED • ELECTRODEPOSITED

REQUIRED PCB HOLE CONSTRUCTION	DRILL (USE ϕ 1.15 METRIC DRILL)	METRIC (mm)
	COPPER THICKNESS	ϕ 1.150 \pm 0.025
PLATED-THROUGH HOLE (PTH) DIAMETER	ϕ 1.05 + 0.04 - 0.05 RECOMMENDED: 1.07 \pm 0.02	

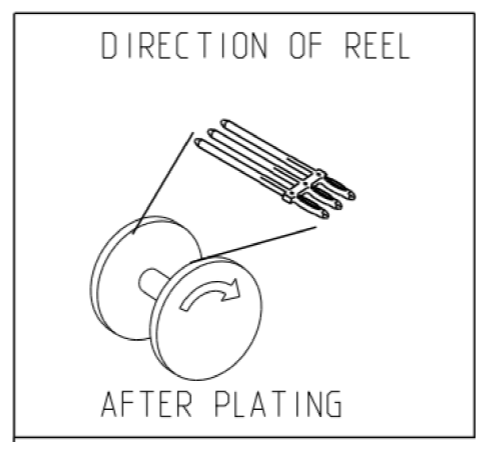
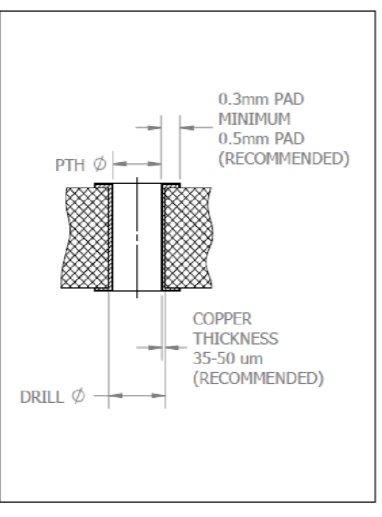

REV.	ZONE	DESCRIPTION	DRAWN BY DD/MM/YYYY	CHECKED BY DD/MM/YYYY	APPROVED BY DD/MM/YYYY	CHANGE NO
A	-	INITIAL RELEASED	Yin LIU 2023-11-28	-	Sohrab.MORADI 2023-11-28	-
B		CHANGE TO ENNOVI DRAWING TEMPLATE	Yin LIU 2024-6-28		Sohrab MORADI 2024-6-28	

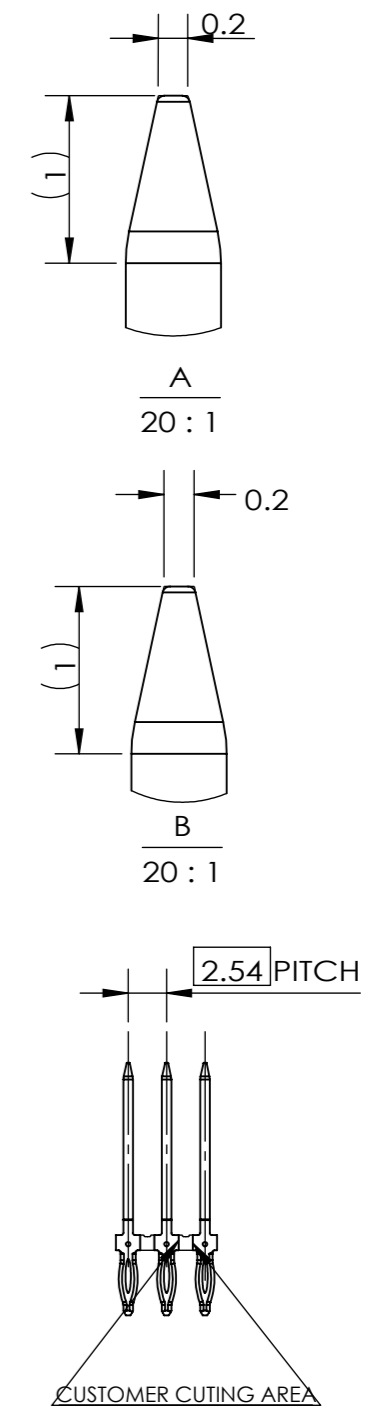
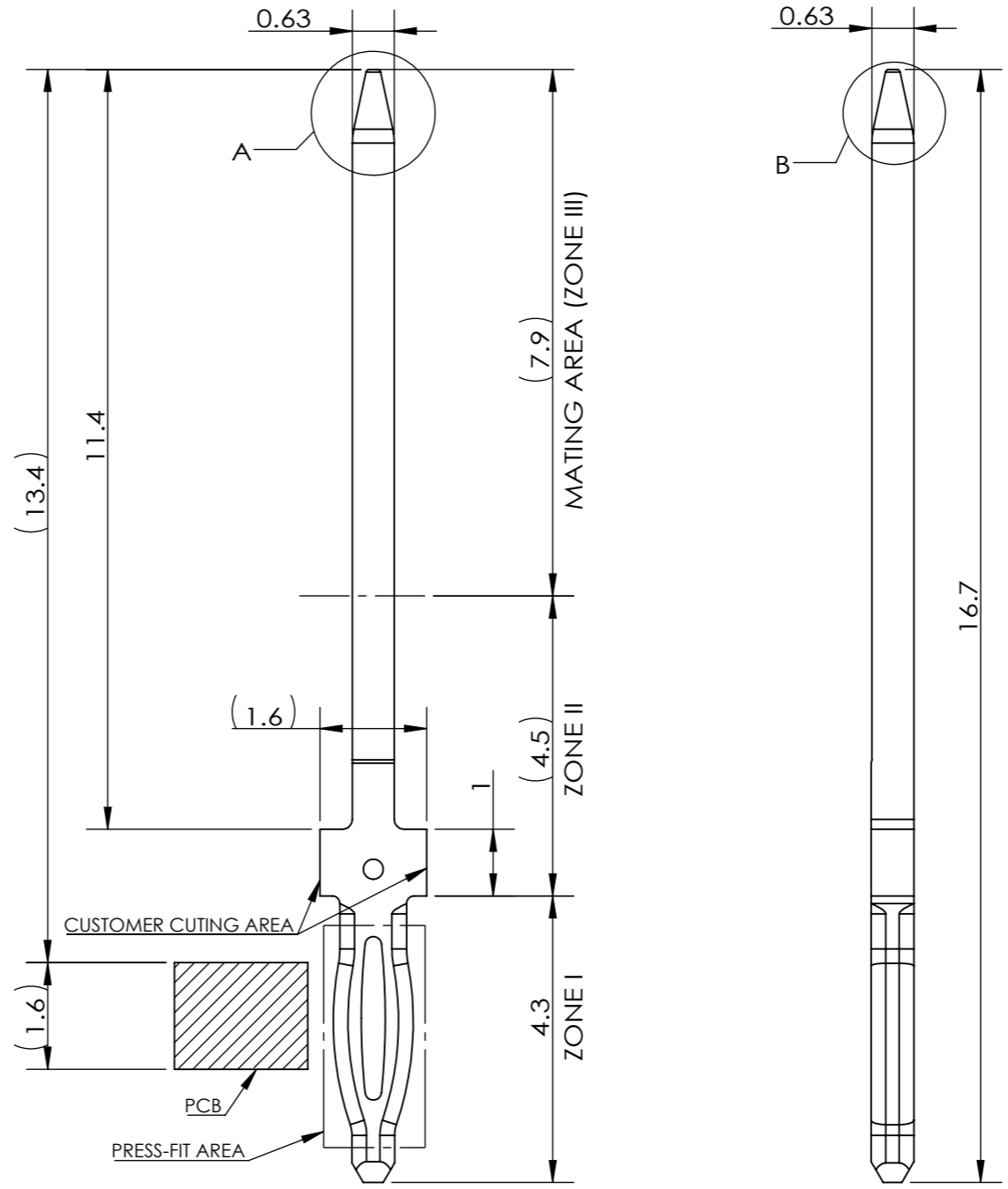

UNLESS OTHERWISE SPECIFIED DIMENSIONS ARE IN MM
FUNDAMENTAL TOLERANCING PRINCIPLE ISO 8015
FOR MISSING DIMENSIONS REFER TO 3D MODEL

GENERAL TOLERANCE: -

MATERIAL: CuNiSi R580 (C19010 R580)

WEIGHT: -

SURFACE FINISH: IndiCoat

THIRD ANGLE PROJECTION

DRAWN	SEE REVISION TABLE
CHECKED	
APPROVED	

ENNOVI™

THIS DRAWING CONTAINS INFORMATION THAT IS THE PROPERTY OF ENNOVI™ AND SHOULD NOT BE USED WITHOUT WRITTEN PERMISSION

TITLE: 0.64 EON PRESS-FIT 0.63 SQUARE

SCALE: -

DRAWING NO.: IA6251

DESCRIPTION: -

SIZE: A3

SHEET: 1 / 1

NOTES (UNLESS OTHERWISE SPECIFIED):

- MATERIAL:**
 - COPPER ALLOY; SEE CHART FOR OPTIONS
- EYE FINISH:**
 - POST-PLATED PER DRAWING E-MLG03035-FIN
- PCB HOLE REQUIREMENTS:**
 - SEE REQUIRED PCB HOLE CONSTRUCTION CHART
- MAX TEMP. RATING IS TEMPERATURE AT WHICH MATERIAL BEGINS TO STRESS RELAX. THE PCB GLASS TRANSITION TEMPERATURE RATING (T_g) MUST ALSO BE 20°C HIGHER THAN MAX APPLICATION TEMPERATURE FOR PROPER INTERFACE PERFORMANCE.**
- DIMENSIONS AND GEOMETRIES SHOWN ARE SYMBOLIC REPRESENTATIONS ONLY.**
- CONSULT PRODUCT ENGINEERING FOR POSSIBLE DIMENSIONAL CHANGES.**

AVAILABLE ALLOYS		
TYPE	% IACS	MAX. TEMP. RATING
PHOSPHOR BRONZE	13-18	125°C
HI-PERFORMANCE ALLOY	50	175°C
HI-CONDUCTIVITY ALLOY	75-80	200°C

REVISIONS			
REV.	DESCRIPTION	DATE	APPROVED
A	INITIAL RELEASE	9/14/2007	RLS
B	UPDATE	2/29/2008	RLS
C	ADDED PCB HOLE CONSTRUCTION SKETCH	4/4/2009	JDP
D	UPDATED AVAILABLE ALLOYS CHART	10/16/2009	JDP
E	UPDATED DRAWING VIEWS AND NOTES	12/05/2013	JDP
F	UPDATED ALLOY CHART, PRESS-FIT LGTH & ADD TOL.	06/20/2014	YF
G	UPDATED PCB HOLE CONSTRUCTION CHART NOTE	06/21/2014	YF
H	UPD. PCB HOLE CONSTRUCT. CHART, DIML. NOTES	04/18/2018	YF
J	UPD. DIM SCHEME, ADD NOTE#5 & #6, UPD. VIEWS & NOTES	10/30/2020	YF

		METRIC (mm)
REQUIRED PCB HOLE CONSTRUCTION	DRILL (USE $\phi 1.15$ METRIC DRILL)	$\phi 1.150 \pm 0.025$
	COPPER THICKNESS	0.050 ± 0.025
	PLATED-THROUGH HOLE (PTH) DIAMETER	$\phi 1.05 \begin{matrix} +0.04 \\ -0.05 \end{matrix}$

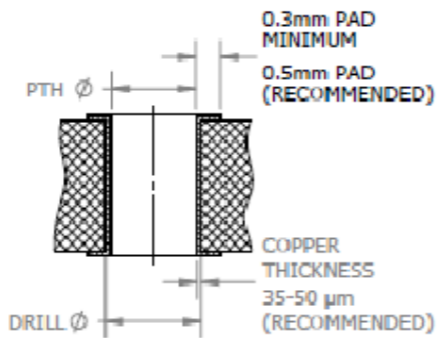

COMPATIBLE PCB HOLE PLATING OPTIONS:

- IMMERSION TIN
- IMMERSION SILVER
- ELECTROLESS NICKEL IMMERSION GOLD (ENIG)
- ORGANIC SOLDERABILITY PRESERVATIVE (OSP)

APPLICABLE FOR NOMINAL PCB THICKNESS 1.0mm OR THICKER.
CONSULT PRODUCT ENGINEERING FOR OTHER PCB THICKNESS, PLATING, AND CONSTRUCTION

SUGGESTED APPLICATION DESIGN PRACTICES

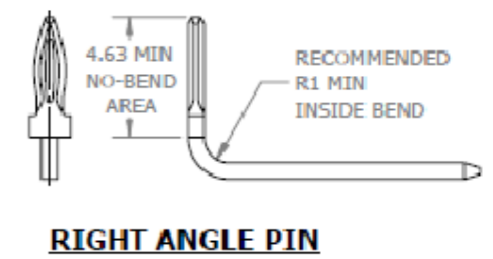
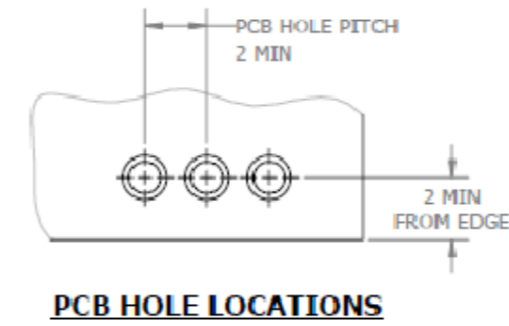
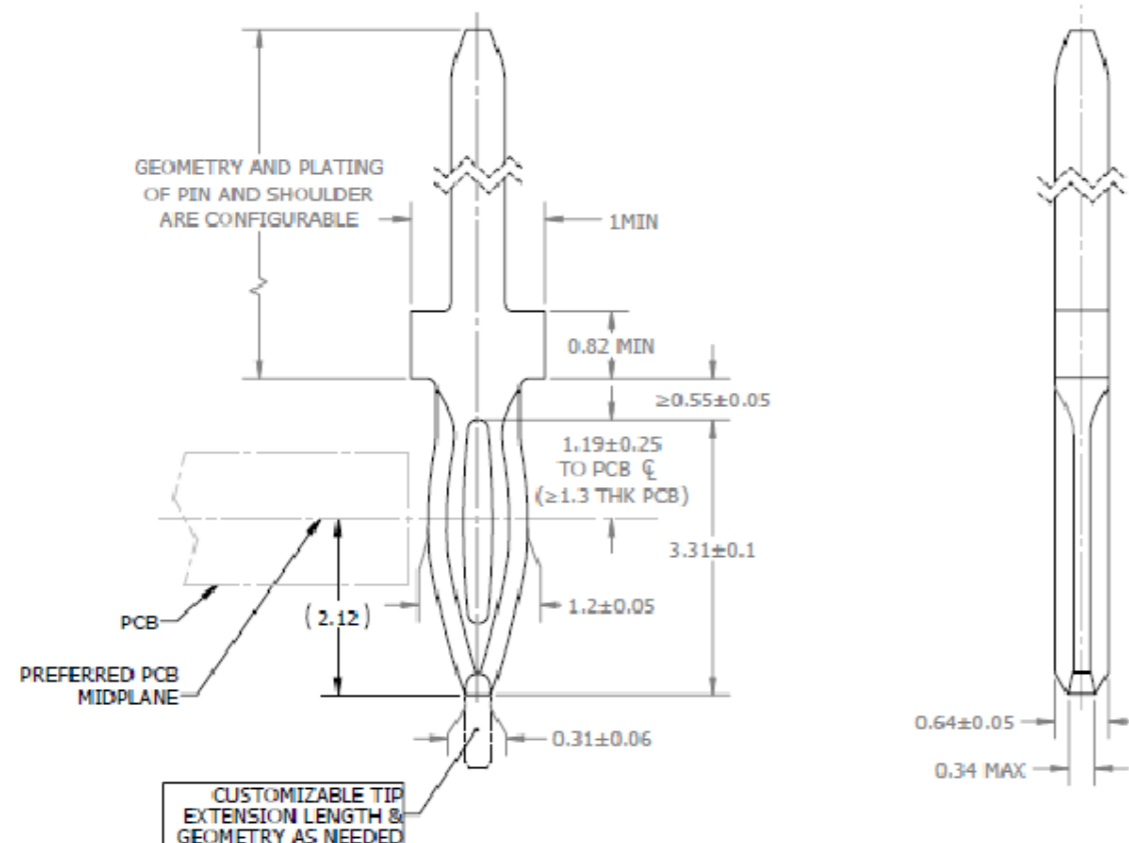
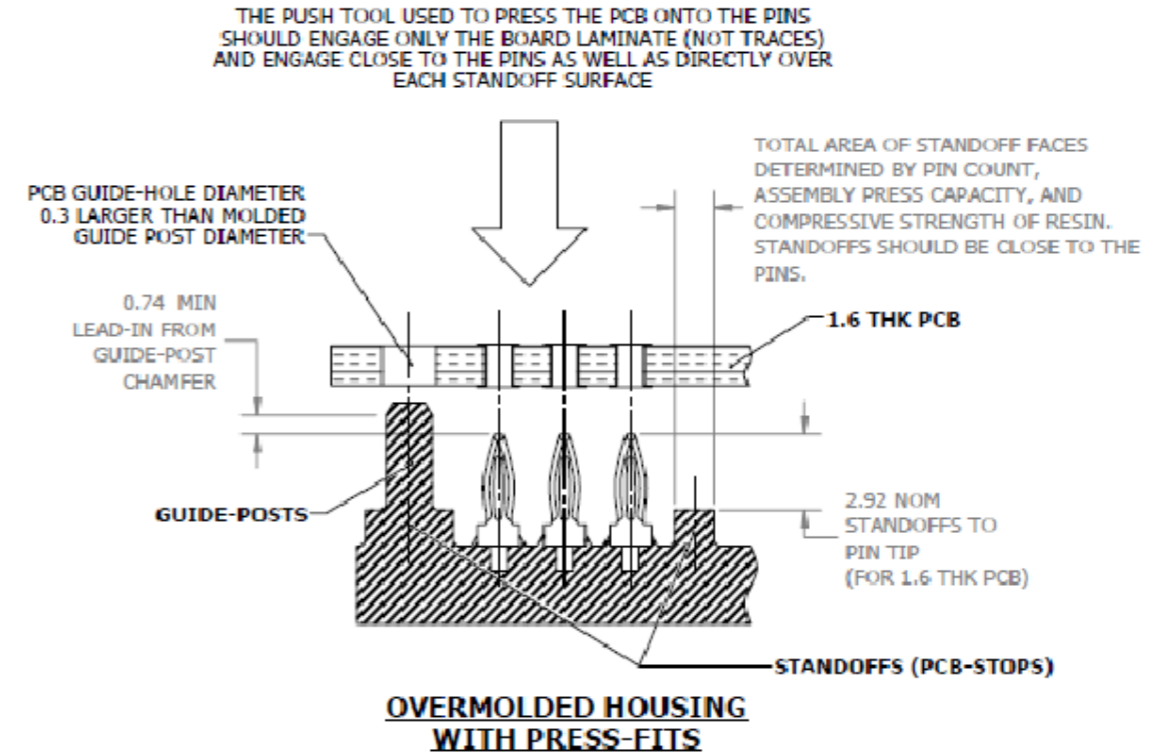

PROPRIETARY AND CONFIDENTIAL
THE INFORMATION CONTAINED IN THIS DRAWING IS THE SOLE PROPERTY OF INTERPLEX INDUSTRIES. ANY REPRODUCTION IN PART OR AS A WHOLE WITHOUT THE WRITTEN PERMISSION OF INTERPLEX INDUSTRIES IS PROHIBITED.

UNITS: mm		NAME: V. RUIJDA		DATE: 10/02/2020	
MATERIAL: SEE NOTES		DRAWN: V. RUIJDA		CHECKED: C. TORIGIAN	
FINISH: SEE NOTES		P/R: 064_EON_105		TITLE: 0.64 EON PRESS-FIT APPLICATION	
DO NOT SCALE DRAWING		SIZE: C		DWG. NO.: E-MLG03035-APP	
				REV: J	
				SHEET 1 OF 1	